

IMPORTANT: Read all instructions before installing fixtures. Retain for future reference.

TOOL REQUIRED

- Saw
- Flat Screwdriver
- Wire Stripper
- Measuring Tape
- Electrical Wiring (use type and gauge suitable for all applications to connect to fixtures)



QUESTIONS
E: info@nadair.com
T: 1 800 776-7891
www.nadair.com



SAFETY / WARNING

SAFETY: For your safety, this fixture must be wired in accordance with local electrical codes and ordinances. All work should be done by a qualified electrician.

WARNING: Make certain power is OFF from the electrical panel before starting installation or attempting any maintenance.

INSTRUCTIONS

STEP 1 -> Shut power OFF

STEP 2 -> Cut ceiling hole using the provided stencil.

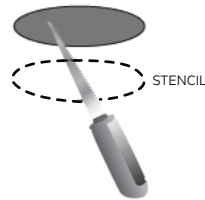

STEP 3 -> With a flat screwdriver, open the junction box cover and remove the appropriate knockout(s) on the side panel.

* STRIPP WIRE
3/4" TO 1"

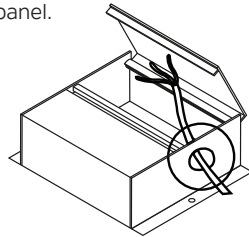
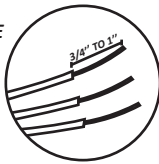

STEP 4 -> Insert the electrical cable through the knockout.

STEP 5 -> Using the QUICK CONNECT feature, connect green (ground) wire of cable to the green wire in the box. Connect white (neutral) wire of cable to the white wire of the box. Connect black wire of cable to black wire of the box.

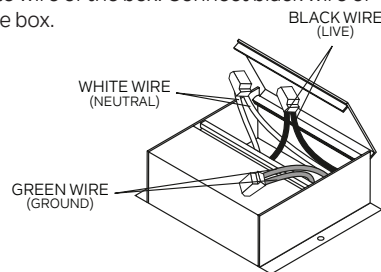

STEP 7 -> Join both white cables in order to affix the slim light to the junction box.

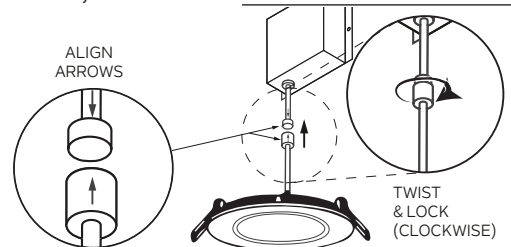

STEP 8 -> Insert junction box through the mounting hole

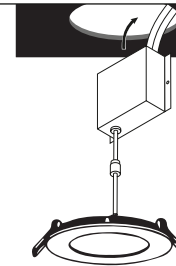

STEP 9 -> (Applies when an additional trim is used to change the color of the finish. If this does not apply, go to step 10)

A) Install and secure the trim on top of the slim light

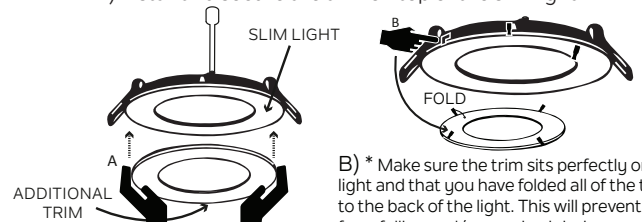

B) * Make sure the trim sits perfectly on the slim light and that you have folded all of the trim tabs to the back of the light. This will prevent the trim from falling and/or causing injuries.

STEP 6 -> Place all wiring and connections back into the junction box.

STEP 7 -> Choose desired color temperature setting (3000K-4000K or 5000K), before closing the box cover.

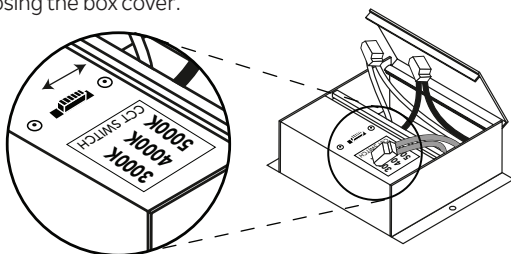

STEP 10 -> A) Push spring loaded clips on the fixture upwards and insert the fixture base into the mounting hole.

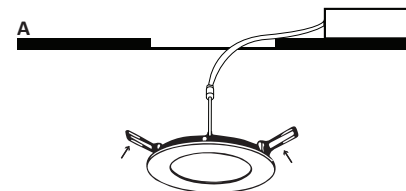

B) Release the clips and the fixture will be pulled flush to the ceiling.

